



SAFETY BULLETIN: LIFTING HARDWARE ALERT

From The NPCA Safety Committee

This alert is intended to inform both precasters and contractors of the potential hazards with engineered lifting hardware regarding used clutches as well as differences between manufacturers lifting inserts and lifting hardware (clutches). There is currently no national standard for the manufacturing of this hardware. Each manufacturer has their own standard with varying dimensions, tolerances and capacities. As there is no national standard for the manufacturers to follow, there is no guarantee that parts from different manufacturers will work together as intended and designed. Dimensions and load ratings must be verified prior to using a clutch from Manufacturer A with a lifting anchor from Manufacturer B.

This document is intended to supply nonproprietary information that applies to curved bolt and knuckle (dog bone) clutches. Contact your lifting device suppliers for additional information and clarification on the following inspection specifications. General inspection points are shown below.

Curved Bolt Clutches

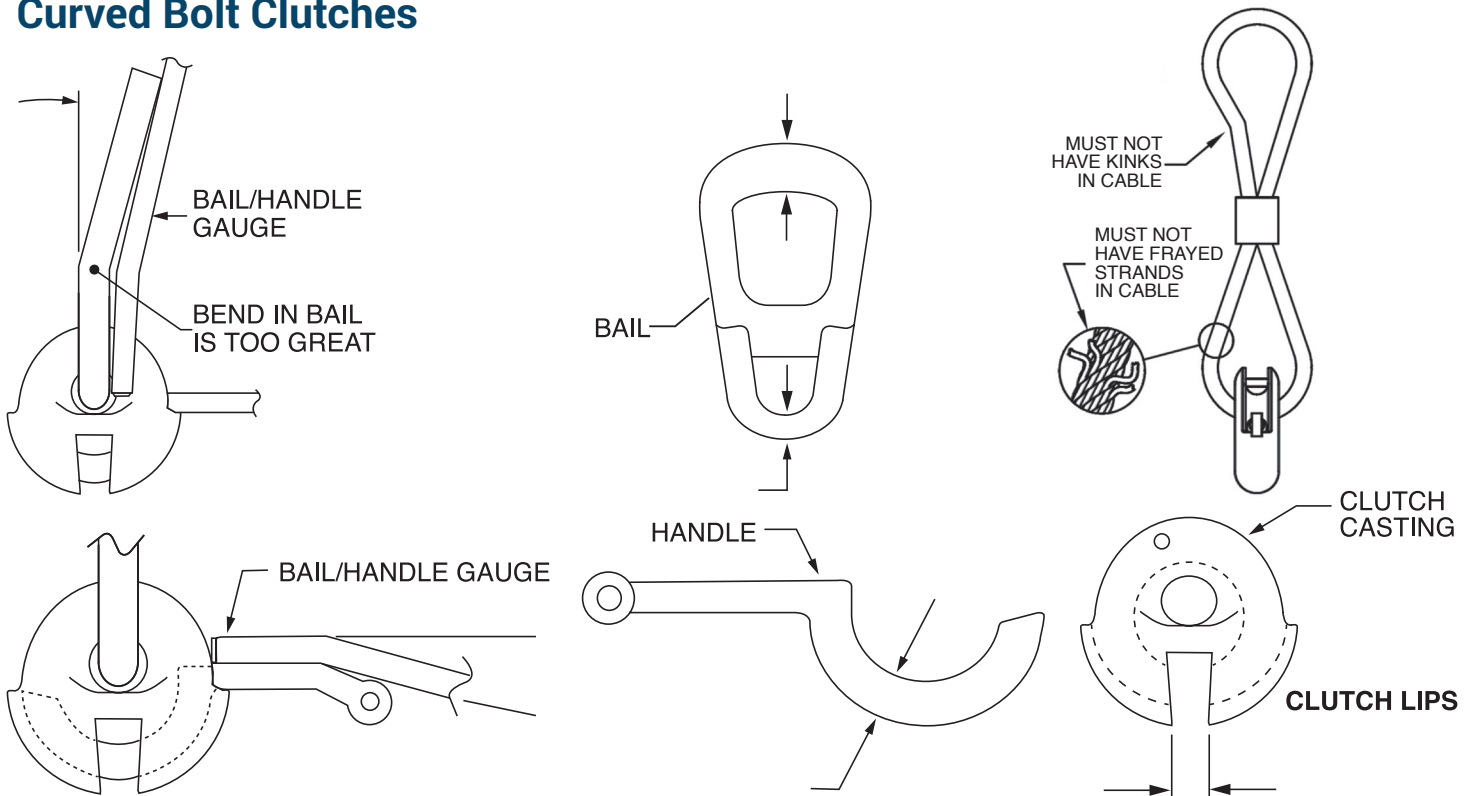

Dog Bone or Knuckle Clutches

